

- HOSEBED CAPACITIES
- ① 400' OF 1.75" HOSE
 - ② 500' OF 2.50" HOSE
 - ③ 1200' OF 5.00" HOSE
 - ④ 200' OF 1.75" HOSE OVER 300' OF 2.50" HOSE
 - ⑤ 400' OF 1.75" HOSE

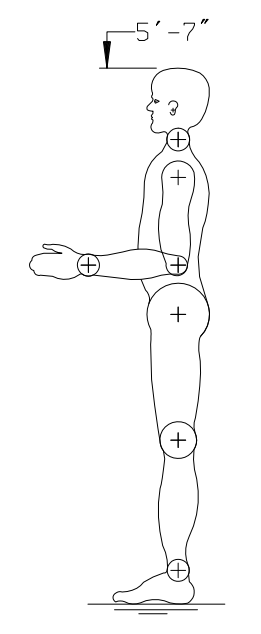
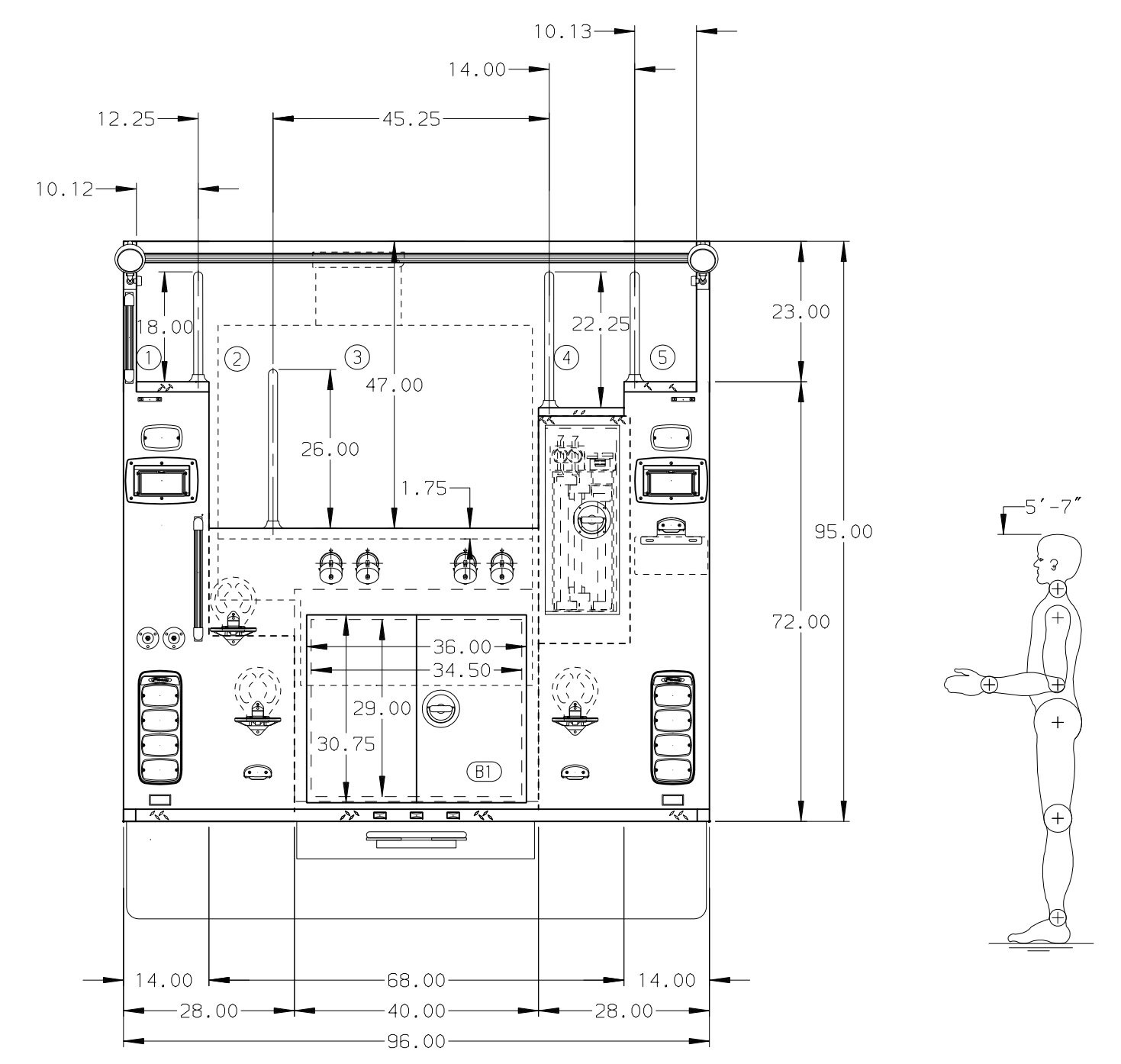

ALUMINUM BODY SIDE ROLL AND FRONTAL IMPACT PROTECTION

NOTE
DIMENSIONS SHOWN ARE APPROXIMATE AND ARE SUBJECT TO MINOR DEVIATIONS AS MAY OCCUR OR BE NECESSARY IN CONSTRUCTION. MINOR DETAILS NOT SHOWN.

CUSTOMER APPROVAL					JOB NO.	PRELIM
APPROVED BY: _____					SCALE	DATE
DATE: _____				TITLE 1500-D-750 GAL POLY, 152" FH FDLER LADDERS BETWEEN TANK AND SIDE SHEET, DELUGE	DRAWN BY	17MAY19
					CHECKED BY	-
				FOR	SOUTH SPRING VALLEY FIRE DISTRICT BID# 518	
				PIERCE	FIREMATIC SUPPLY CO, INC. JEREMY COHEN	
				MODEL	DWG NO.	04-6110
REV	DATE	BY	CH	ARROW XT	SHEET NO.	1 OF 1